

DIN 卡套式管接头

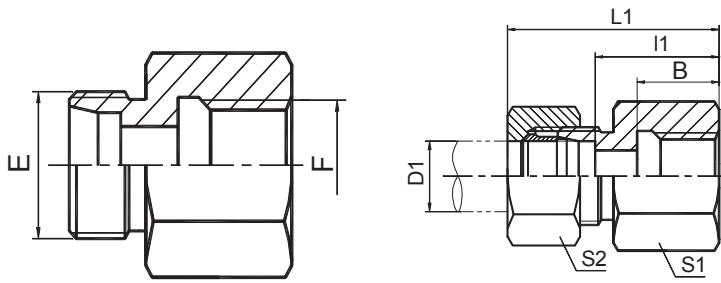

英管内螺纹柱端接头
BSP FEMALE STUD FITTINGS

**5CB
5DB**

**5CB-RN
5DB-RN**

代号 PART NO.	螺纹 THREAD		管子外径 TUBE O.D. D1	尺寸 DIMENSIONS						压力等级 MPa
	E	F		B	l1	L1	S1	S2		
5CB-12-02	M12X1.5	G1/8"X28	6	12	19	34	14	14		31.5 轻系列 L
5CB-12-04	M12X1.5	G1/4"X19	6	16	23	36	19	17		
5CB-14-04	M14X1.5	G1/4"X19	8	17	24	39	19	17		
5CB-14-06	M14X1.5	G3/8"X19	8	17	25	40	24	17		
5CB-14-08	M14X1.5	G1/2"X14	8	20	29	44	27	17		
5CB-16-04	M16X1.5	G1/4"X19	10	17	25	40	19	19		
5CB-16-06	M16X1.5	G3/8"X19	10	17	26	41	24	19		
5CB-16-08	M16X1.5	G1/2"X14	10	20	30	45	27	19		
5CB-18-04	M18X1.5	G1/4"X19	12	17	23	38	19	22		
5CB-18-06	M18X1.5	G3/8"X19	12	17	26	41	24	22		
5CB-18-08	M18X1.5	G1/2"X14	12	20	30	45	27	22		
5CB-22-06	M22X1.5	G3/8"X19	15	17	28	43	24	27		
5CB-22-08	M22X1.5	G1/2"X14	15	20	31	46	27	27		
5CB-26-08	M26X1.5	G1/2"X14	18	20	30.5	47	27	32		
5CB-30-12	M30X2	G3/4"X14	22	22	35.5	52	36	36		
5CB-36-16	M36X2	G1"X11	28	24.5	38	55	41	41		
5CB-45-20	M45X2	G1.1/4"X11	35	26.5	41	63	55	50		
5CB-52-24	M52X2	G1.1/2"X11	42	28.5	42.5	65	60	60		
5DB-14-04	M14X1.5	G1/4"X19	6	17	26	41	19	17		
5DB-16-04	M16X1.5	G1/4"X19	8	17	26	41	19	19		
5DB-18-06	M18X1.5	G3/8"X19	10	17	26.5	43	24	22		
5DB-20-06	M20X1.5	G3/8"X19	12	17	27.5	28	24	24		
5DB-20-08	M20X1.5	G1/2"X14	12	20	30.5	31	24	24		
5DB-22-08	M22X1.5	G1/2"X14	14	20	32	50	30	27		
5DB-24-08	M24X1.5	G1/2"X14	16	20	31.5	50	30	30		
5DB-30-12	M30X2	G3/4"X14	20	22	34.5	56	36	36		
5DB-36-16	M36X2	G1"X11	25	24.5	37.5	62	41	46		
5DB-42-20	M42X2	G1.1/4"X11	30	26.5	42	69	55	50		
5DB-52-24	M52X2	G1.1/2"X11	38	28.5	43.5	74	60	60		

注：如需带卡套及卡套螺母整套订货，则请在代号后加“RN”，如5CB-45-20RN。

Note: In case if you are interested to order the adapter in complete set with cutting ring and nut ,it is necessary to insert suffix "RN" after our part no., for example 5CB-45-20RN.